

Information on Disposal for Users of Waste Electrical & Electronic Equipment (private households)



This symbol on the products and/or accompanying documents means that used electrical and electronic products should not be mixed with general household waste.

For proper treatment, recovery and recycling, please take these products to designated collection points, where they will be accepted on a free of charge basis. Alternatively, in some countries you may be able to return your products to your local retailer upon the purchase of an equivalent new product.

Disposing of this product correctly will help to save valuable resources and prevent any potential negative effects on human health and the environment which could otherwise arise from inappropriate waste handling. Please contact your local authority for further details of your nearest designated collection point. Penalties may be applicable for incorrect disposal of this waste, in accordance with national legislation.

For business users in the European Union

If you wish to discard electrical and electronic equipment, please contact your dealer or supplier for further information.

Information on Disposal in other Countries outside the European Union

This symbol is only valid in the European Union.

If you wish to discard this product, please contact your local authorities or dealer and ask for the correct method of disposal.

Panasonic[®]

**Operating Instructions
Plasma Television**

Model No. **TH-37PV60EH**
TH-42PV60EH

VIERA



Customer's Record

The model number and serial number of this product may be found on its rear panel. You should note this serial number in the space provided below and retain this book, plus your purchase receipt, as a permanent record of your purchase to aid in identification in the event of theft or loss, and for Warranty Service purposes.

Model Number

Serial Number

Matsushita Electric Industrial Co., Ltd.

Web Site : <http://www.panasonic-europe.com>

© 2006 Matsushita Electric Industrial Co., Ltd. All Rights Reserved.

Printed in Czech Republic

English

Please read these instructions before operating your set and retain them for future reference.
The images shown in this manual are for illustrative purposes only.



TQB0E0340U

Turn your own living room into a movie theatre!

Experience an amazing level of multi-media excitement

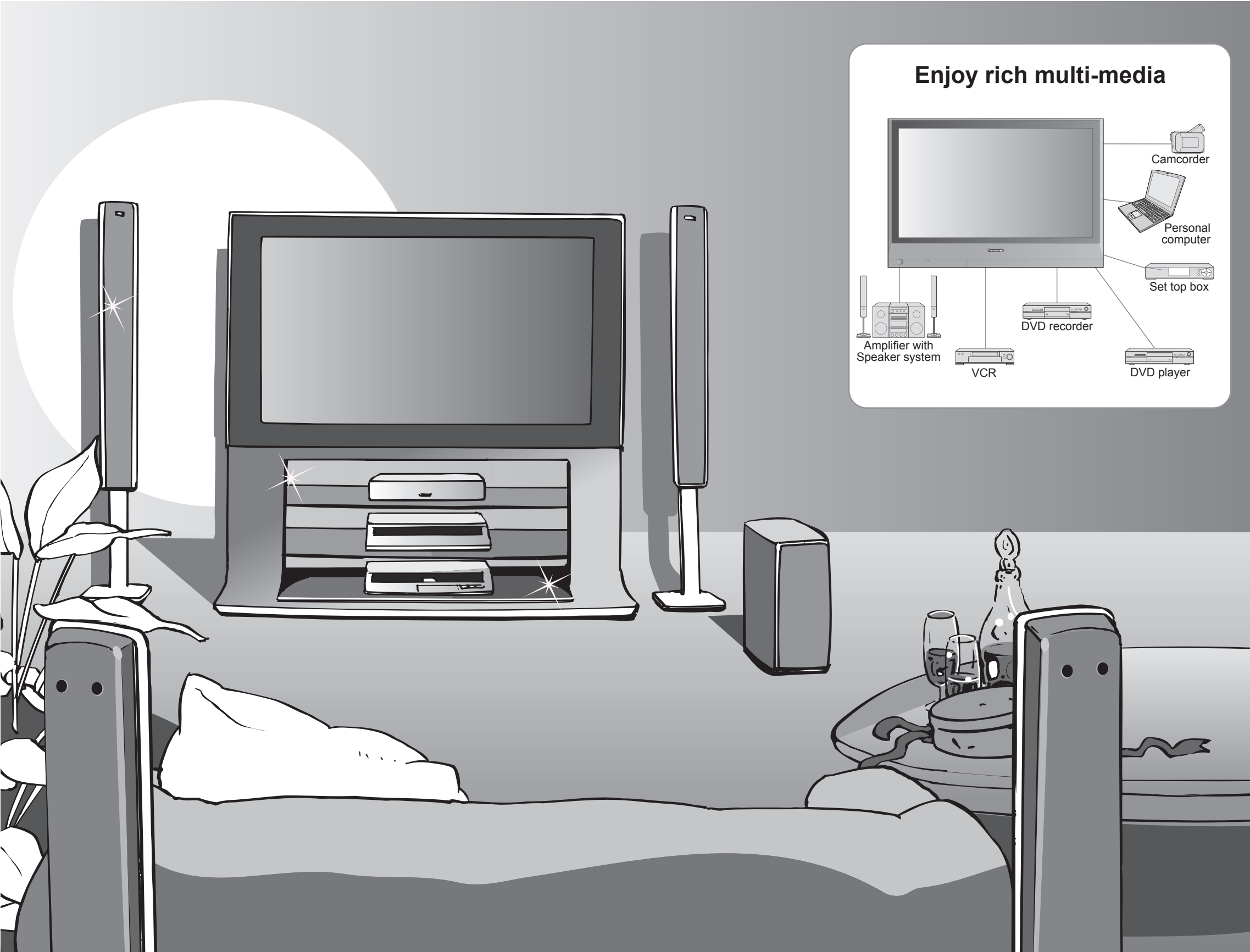

Contents

Be Sure to Read

● Safety Precautions (Warning / Caution)	4
● Notes	5
● Maintenance	5

Quick Start Guide

● Accessories / Options	6
● Identifying Controls	7
● Connection	8
● Auto Setup	9

Enjoy your TV!

Basic Features

● Watching TV	10
● Watching Videos and DVDs	11
● Viewing Teletext	12

Advanced Features

● How to Use Menu Functions (picture, sound quality, etc.)	14
● Editing and Setting Channels	16
● Displaying PC Screen on TV	19
● External Equipment (Q-Link / Control with HDMI / Connections)	20

FAQs, etc.

● Technical Information	26
● FAQs	29
● Licence	31
● Specifications	31

Safety Precautions

Warning

Handling the mains plug and lead

- Insert the mains plug fully into the socket outlet. (If the mains plug is loose, it could generate heat and cause fire.)
- Ensure that the mains plug is easily accessible.
- Ensure the grounding pin on the mains plug is securely connected to prevent electrical shock.
 - An apparatus with CLASS I construction shall be connected to a mains socket outlet with a protective earthing connection.
- Do not touch the mains plug with a wet hand. (This may cause electrical shock.)
- Do not damage the mains lead. (A damaged lead may cause fire or electrical shock.)
 - Do not move the TV with the lead plugged in the socket outlet.
 - Do not place a heavy object on the lead or place the lead near a high-temperature object.
 - Do not twist the lead, bend it excessively, or stretch it.
 - Do not pull on the lead. Hold onto the mains plug body when disconnecting lead.
- Do not use a damaged mains plug or socket outlet.

If you find any abnormality, remove the mains plug immediately! (such as strange smell or smoke)

AC 220-240 V
50 / 60 Hz



Do not remove covers NEVER modify the unit yourself

(High-voltage components may cause serious electrical shock.)

- Have the unit checked, adjusted, or repaired at your local Panasonic dealer.

Do not place foreign objects inside the unit

- Do not let metal or flammable objects drop into the unit through the air vents (fire or electrical shock may result).

Do not expose to direct sunlight and other sources of heat

- Avoid exposing the TV set to direct sunlight and other sources of heat. To prevent fire never place any type of candle or naked flame on top or near the TV set.

Keep liquids away from the TV

- To prevent damage which may result in fire or shock hazard, do not expose this appliance to dripping or splashing.
- Do not place containers with water (flower vase, cups, cosmetics, etc.) above the set. (including on shelves above, etc.)

Do not place the TV on an unstable surface

Use only the dedicated stands / mounting equipment

- Using an unauthorized stand or other fixtures may make the unit shaky, risking injury. Be sure to ask your local Panasonic dealer to perform setup.
- Use optional stands / mounts (p. 6).

Notes

Caution

When cleaning the TV unit, remove the mains plug

(Cleaning an energized unit may cause electrical shock.)

When TV will not be used for a long time, remove the mains plug

- This TV will still consume some power even in the Off mode, as long as the mains plug is still connected to a live socket outlet.

Allow sufficient space around the unit for radiated heat

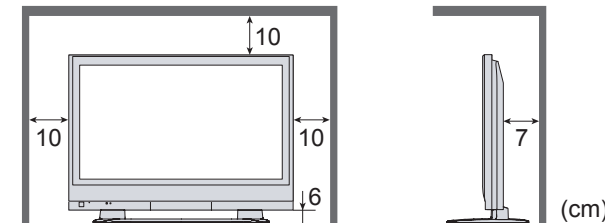

Do not block the rear air vents

- Blocked ventilation by curtains, etc. may cause overheating, fire or electrical shock.



Remember not to keep still pictures on the screen for extended lengths of time

Such still pictures cause after-images on the plasma screen if they are displayed for a long time. These after-images are not considered malfunctions and are not covered by the warranty.

Typical still images

- Channel number and unique logos
- Image displayed in 4:3 mode
- Video game
- Computer image



To decrease the chance of after-images, a screen saver will be automatically activated after a few minutes if there is no signal and if there is no operation in AV mode. (p. 29) The screen saver will be automatically deactivated when a signal is detected or an operation is executed.

Keep the unit away from these equipment

- Electronic equipment
In particular, do not place video equipment near the unit (electromagnetic interference may distort images / sound).
- Equipment with an infrared sensor
This TV also emits infrared rays (this may affect operation of other equipment).

Maintenance

First, remove the mains plug from the socket outlet.

Display panel

Daily care: Gently wipe the surface clean of dirt by using a soft cloth.

Major contamination: Wipe the surface clean using a soft cloth dampened with clean water or water containing a small amount of neutral detergent. Then, using a soft dry cloth, evenly wipe the surface clean until it is dry.

Caution

- The surface of the display panel has been specially treated and may be easily damaged.
Do not tap or scratch the surface with your fingernail or other hard object.
- Use care not to subject the surface to bug repellent, solvent, thinner, or other volatile substances (this may degrade surface quality).

Cabinet

Daily care: Wipe the surface clean using a soft dry cloth.

Major contamination: Dampen a soft cloth with clean water or water containing a small amount of neutral detergent. Then, wring the cloth and wipe the surface clean with it. Finally, wipe the surface clean with a dry cloth.

Caution

- Use care not to subject the TV unit's surfaces to detergent.
(A liquid inside the TV unit could lead to product failure.)
- Use care not to subject surfaces to bug repellent, solvent, thinner, or other volatile substances (this may deteriorate the surface by peeling the paint).
- Do not allow the cabinet to make contact with a rubber or PVC substance for a long time.

Mains plug

Wipe the mains plug with a dry cloth at regular intervals. (Moisture and dust may lead to fire or electrical shock.)

Accessories / Options

Standard accessories

- ☐ Remote Control Transmitter
- EUR765109A



Check that you have the accessories and items shown ☒

- ☐ Batteries for the Remote Control Transmitter (2)
- R6 (UM3)



- ☐ Operating Instructions
- ☐ Pan European Guarantee Card

- ☐ Ferrite core
- J0KF00000018

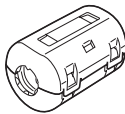

- ☐ Pedestal
- TBL0E0001 or TBL0E0002

(equivalent to optional accessory TY-ST42P60W)

Read the manual of the pedestal for installation.

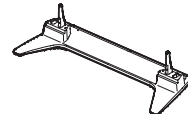

- ☐ Clamper (2)

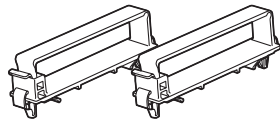

- ☐ Mains Lead



Installing remote's batteries

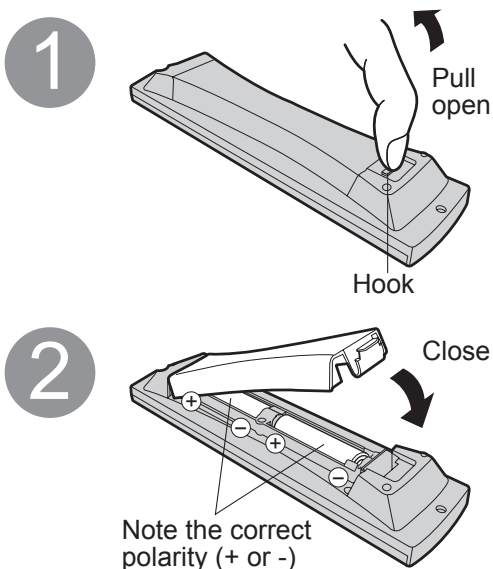

Caution

- Incorrect installation may cause battery leakage and corrosion, resulting in damage to the remote control.
- Do not mix old and new batteries.
- Do not mix different battery types (such as alkaline and manganese batteries).
- Do not use rechargeable (Ni-Cd) batteries.
- Do not burn or breakup batteries.

Attaching the cable clampers

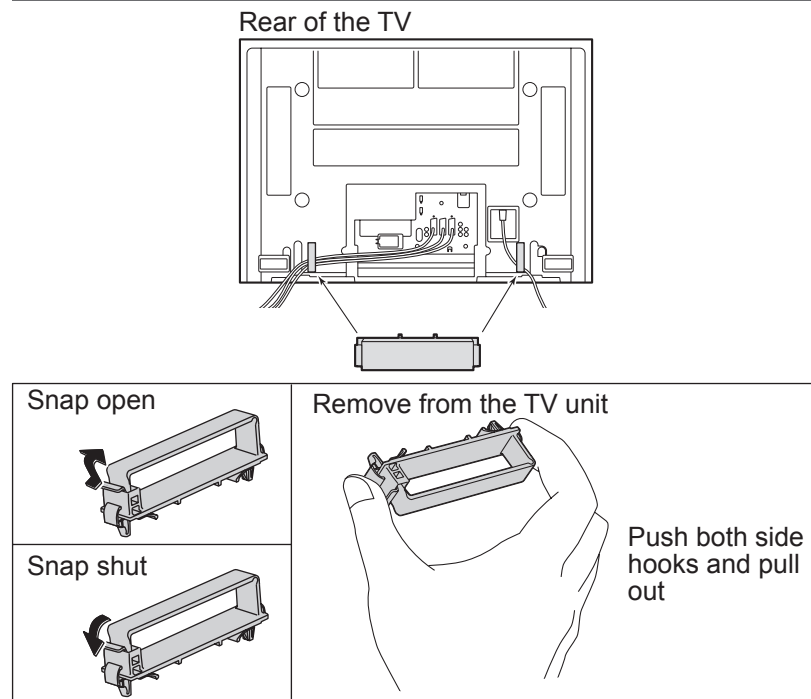

- Do not bundle the RF cable and mains lead together (could cause distorted image).
- Fix cables with clampers as necessary.
- When using the optional accessory, follow the option's assembly manual to fix cables.

Optional accessories

Pedestal

- TY-ST42P600W



- TY-ST42P60W

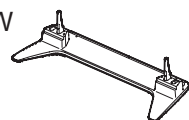

Plasma TV stand

- TY-S37PX60W (TH-37PV60EH)

- TY-S42PX60W (TH-42PV60EH)

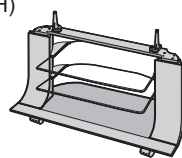

Wall-hanging bracket (vertical)

- TY-WK42PV3W

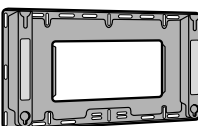

(angle)

- TY-WK42PR2W

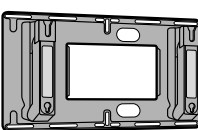

Caution

- In order to maintain the unit's performance and safety, be absolutely sure to ask your dealer or a licenced contractor to secure the wall-hanging brackets.
- Carefully read the instructions accompanying the plasma TV stand or pedestal, and be absolutely sure to take steps to prevent the TV from tipping over.
- Handle the TV carefully during installation since subjecting it to impact or other forces may cause product damage.

Identifying Controls

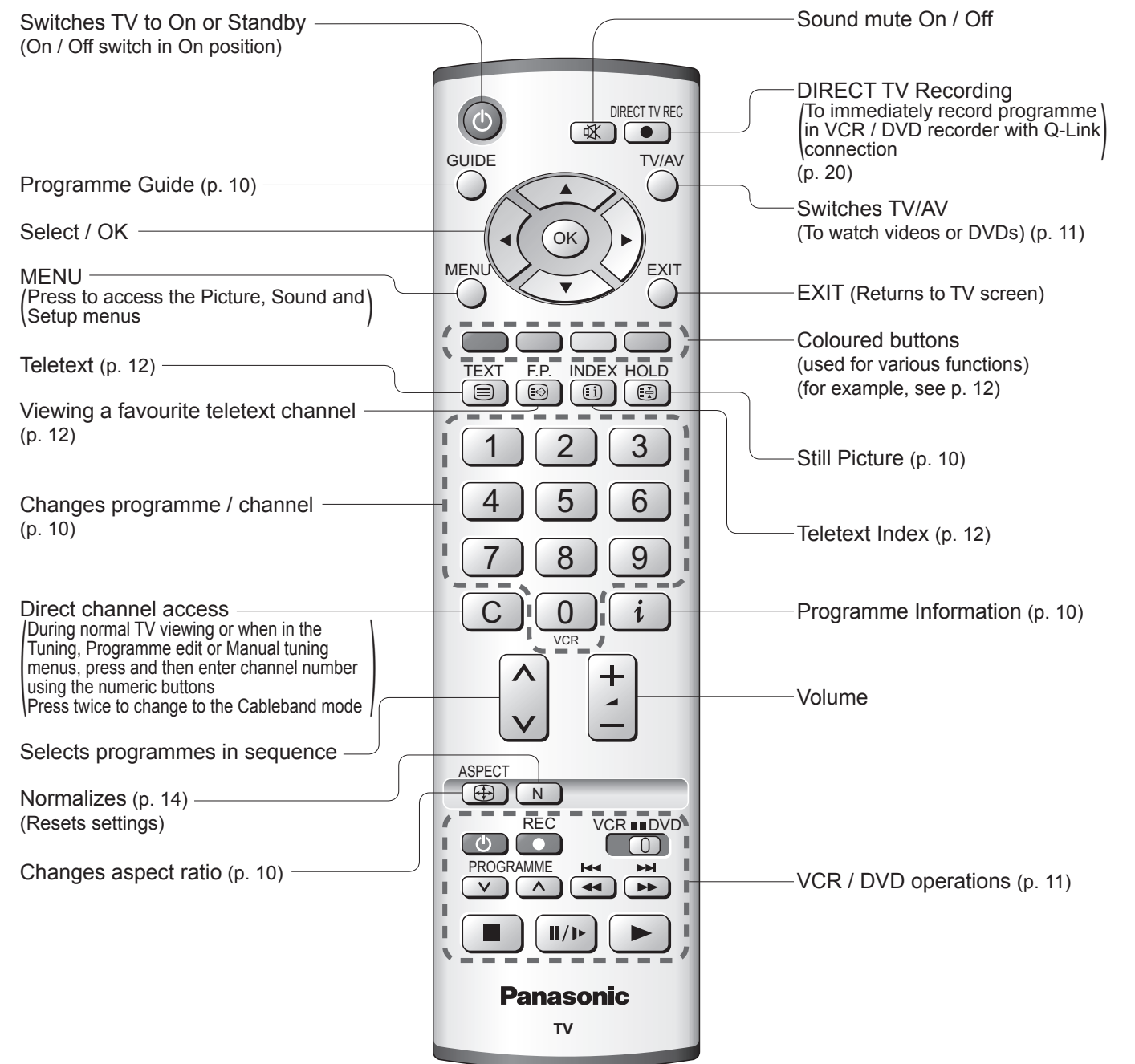
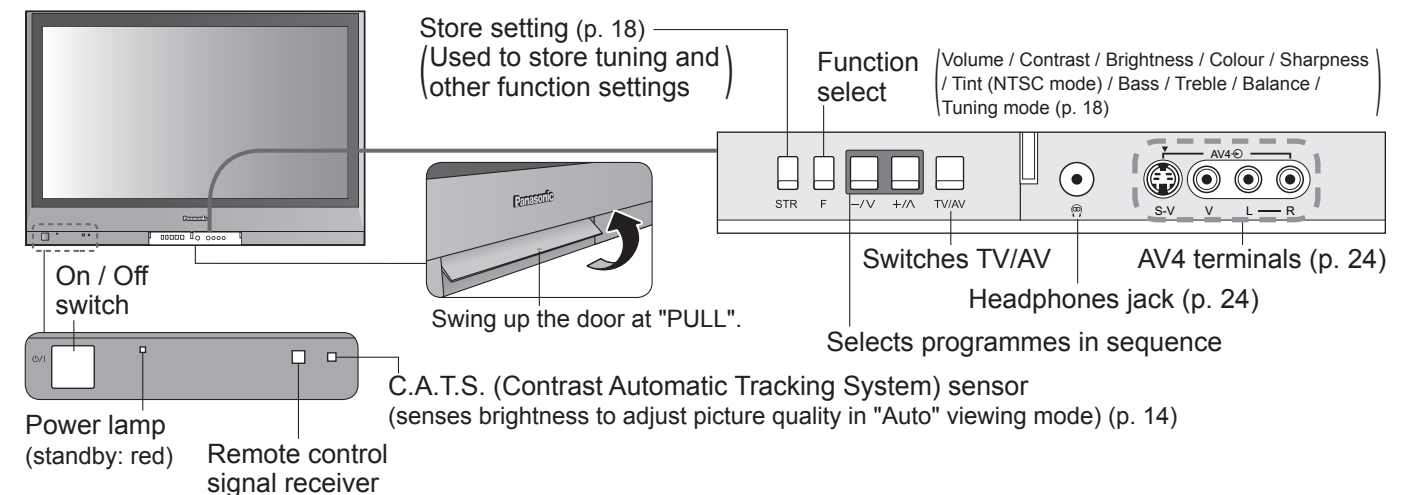

Connection

External equipments and cables shown in this manual are not supplied with this TV.
Please ensure that the unit is disconnected from the mains before attaching or disconnecting any leads.

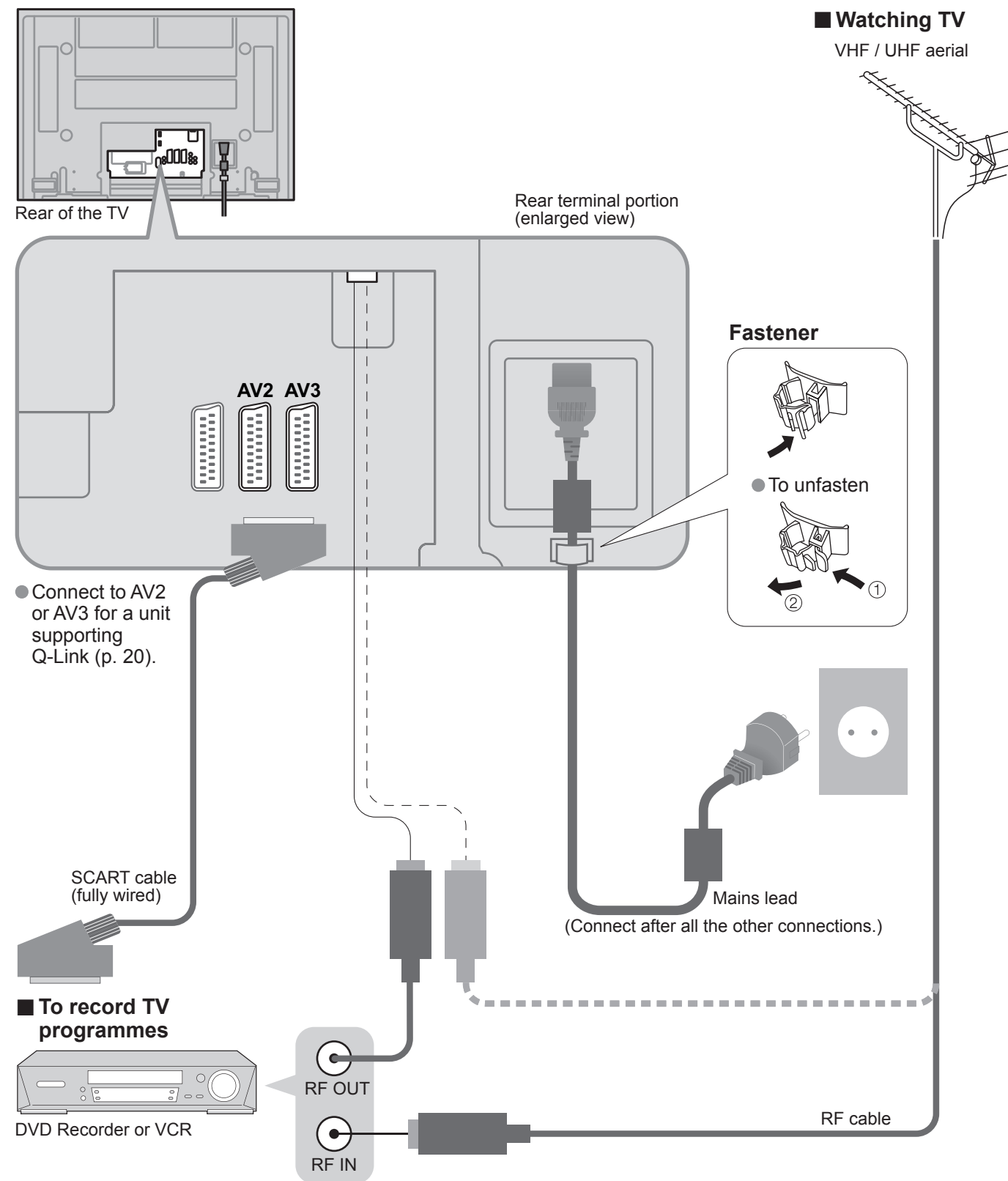

Auto Setup



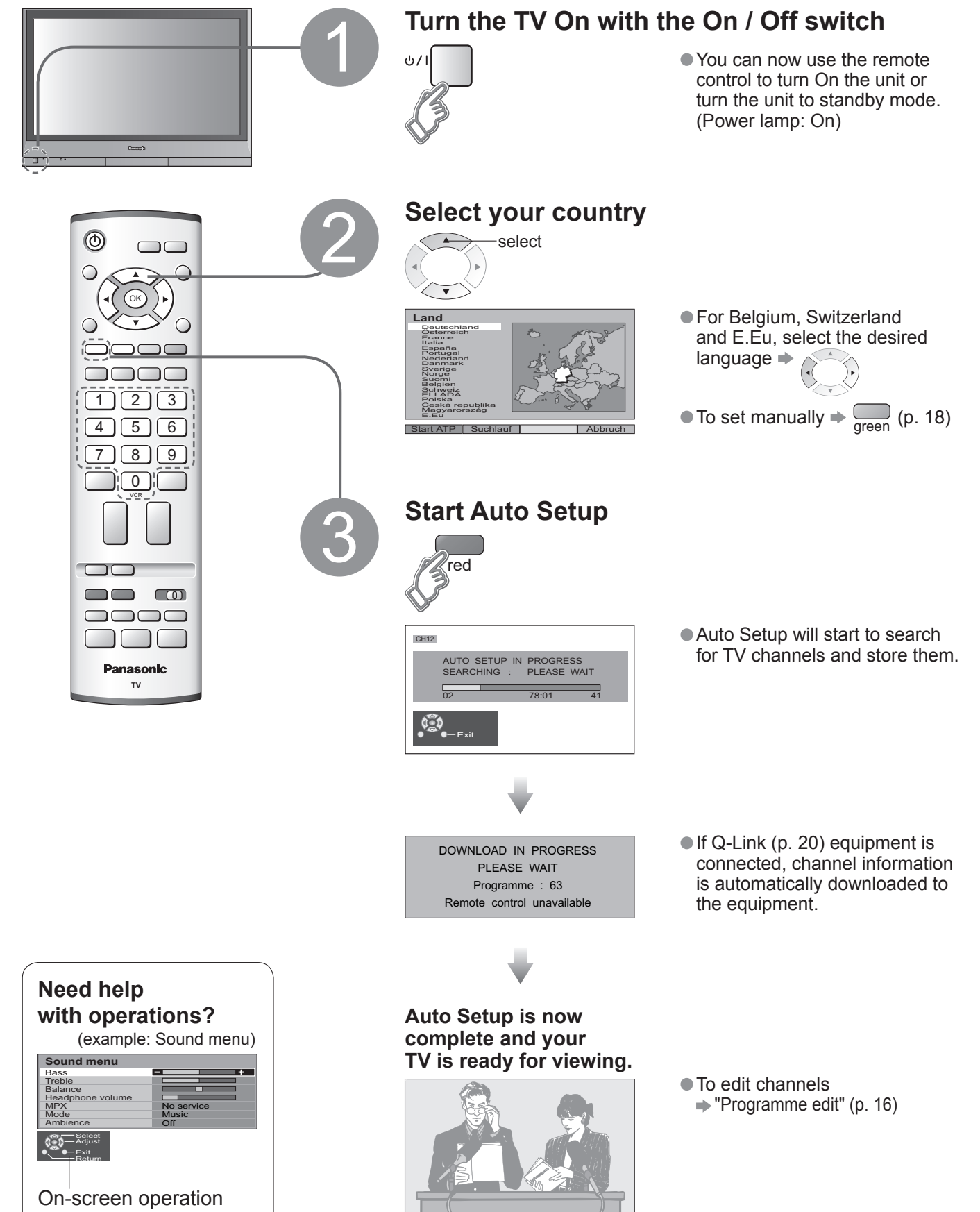

Search and store TV channels automatically.
These steps are not necessary if the setup has been completed by your local dealer.

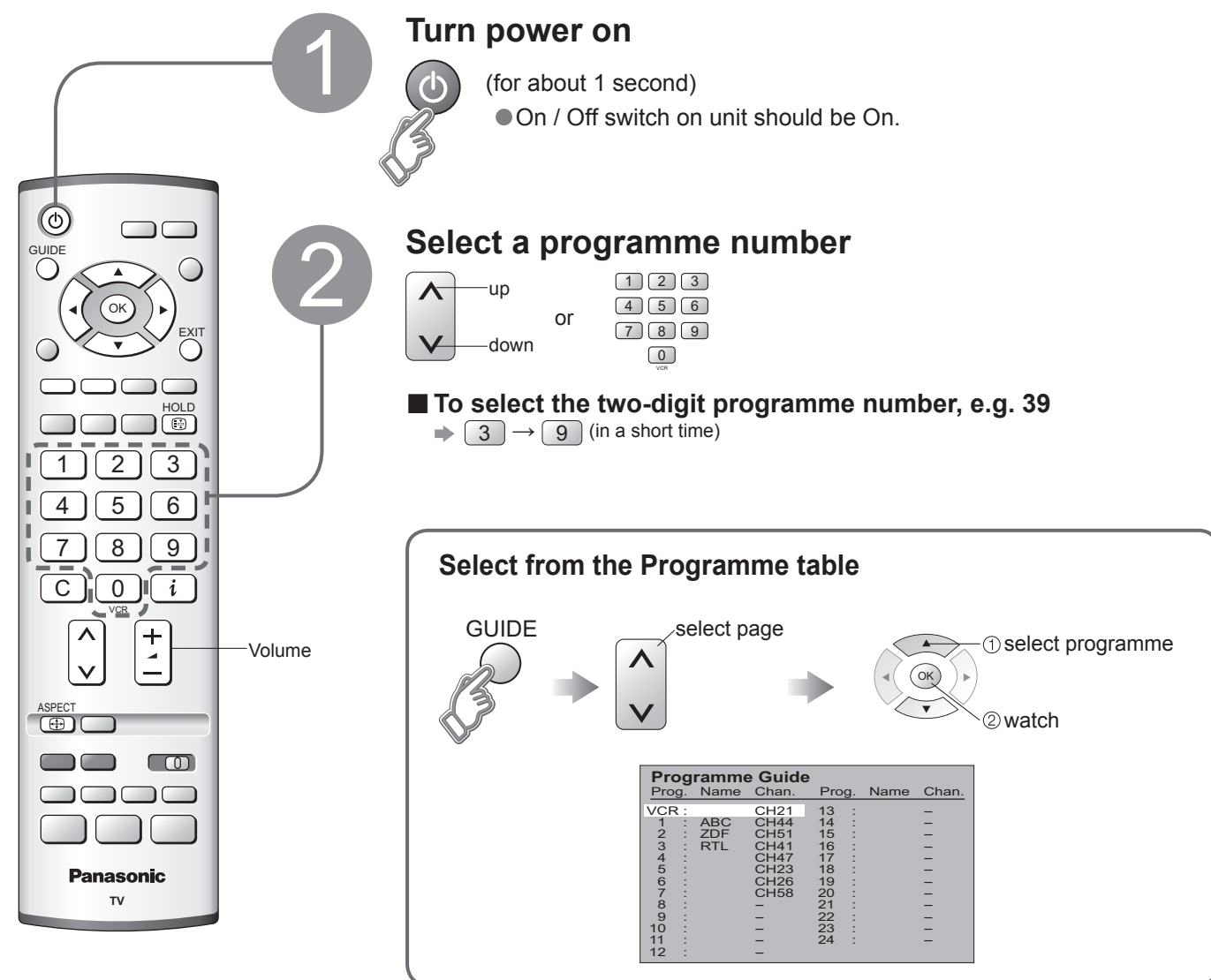

Watching TV



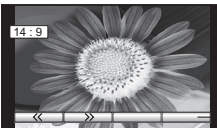







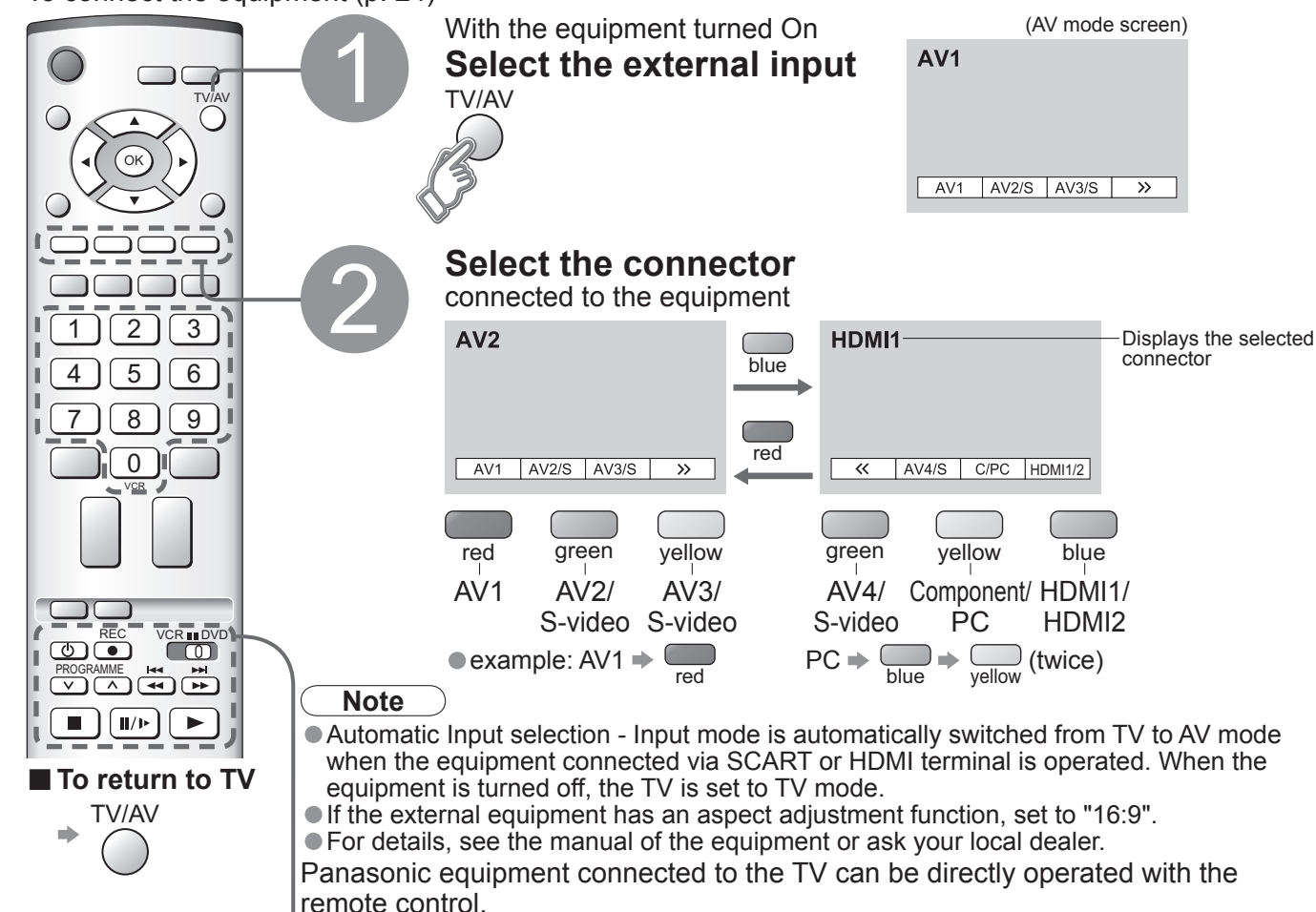

■ Other Useful Functions (Operate after ②)

Hold	Freeze / unfreeze picture 	
	Display / hide status information  <ul style="list-style-type: none"> ● Displayed information: Programme number / Programme name / Channel number / MPX mode (p. 14) / Sound system (p. 14) / Aspect mode 	
Change aspect ratio	Change the aspect ratio (p. 26) 	
		<ul style="list-style-type: none"> ● Each press changes the mode. (Auto aspect / 16:9 / 14:9 / Just / 4:3 / 4:3 Full) (HD signal only) / Zoom1 / Zoom2 / Zoom3 <p>While the bar is displayed</p>  <p>red green</p>





Watching Videos and DVDs

It is possible to connect a variety of external equipment to the TV unit. Once the equipment is connected, use the following procedure to view the input.
To connect the equipment (p. 24)



Front control	
 VCR / DVD switch* Select VCR to operate Panasonic VCR or DVD equipment Select DVD to operate Panasonic DVD equipment or Player theatre	 Fast-forward / Skip / Search VCR: Fast-forward, cue (during playback) DVD: Skip to the next track or title Press and hold to search forward
 Standby Set to Standby mode / Turn on	 Pause Pause / Restart DVD: Press and hold for slow-motion play
 Play Playback VCR / DVD	
 Stop Stop the operations	PROGRAMME  Programme Up / Down Select programme
 Rewind / Skip / Search VCR: Rewind, review (during playback) DVD: Skip to the previous track or title Press and hold to search backward	
	REC  Record Start recording

*The remote control will be available for various Panasonic equipment with the following settings.

- ① Switch to select VCR or DVD you want to change → 
- ② Press and hold  → Enter the code below (two digit code)  → Press 

Equipment	Code
VCR	10 (default)
DVD	11

Equipment	Code
DVD	70 (default)
Player theatre	71

Note

- After setting, execute operation confirmation.
- The respective VCR / DVD code is turned to the default when battery has been exchanged. Set it again.
- Depending on the model, operation may not be possible.

Viewing Teletext

You can enjoy teletext broadcasting, including news, weather forecasts and subtitles, if this service is provided by the broadcasters.

What is TOP / FLOF mode?

In TOP / FLOF mode, four differently coloured subjects are situated at the bottom of the screen. To access more information about one of these subjects, press the appropriately coloured button. This facility enables fast access to information on the subjects shown.

What is List mode?

In List mode, four differently coloured page numbers are situated at the bottom of the screen. Each of these numbers can be altered and stored in the TV's memory. ("Store Frequently viewed pages", p. 13)

■ To change mode → "Teletext" in Setup menu (p. 14)

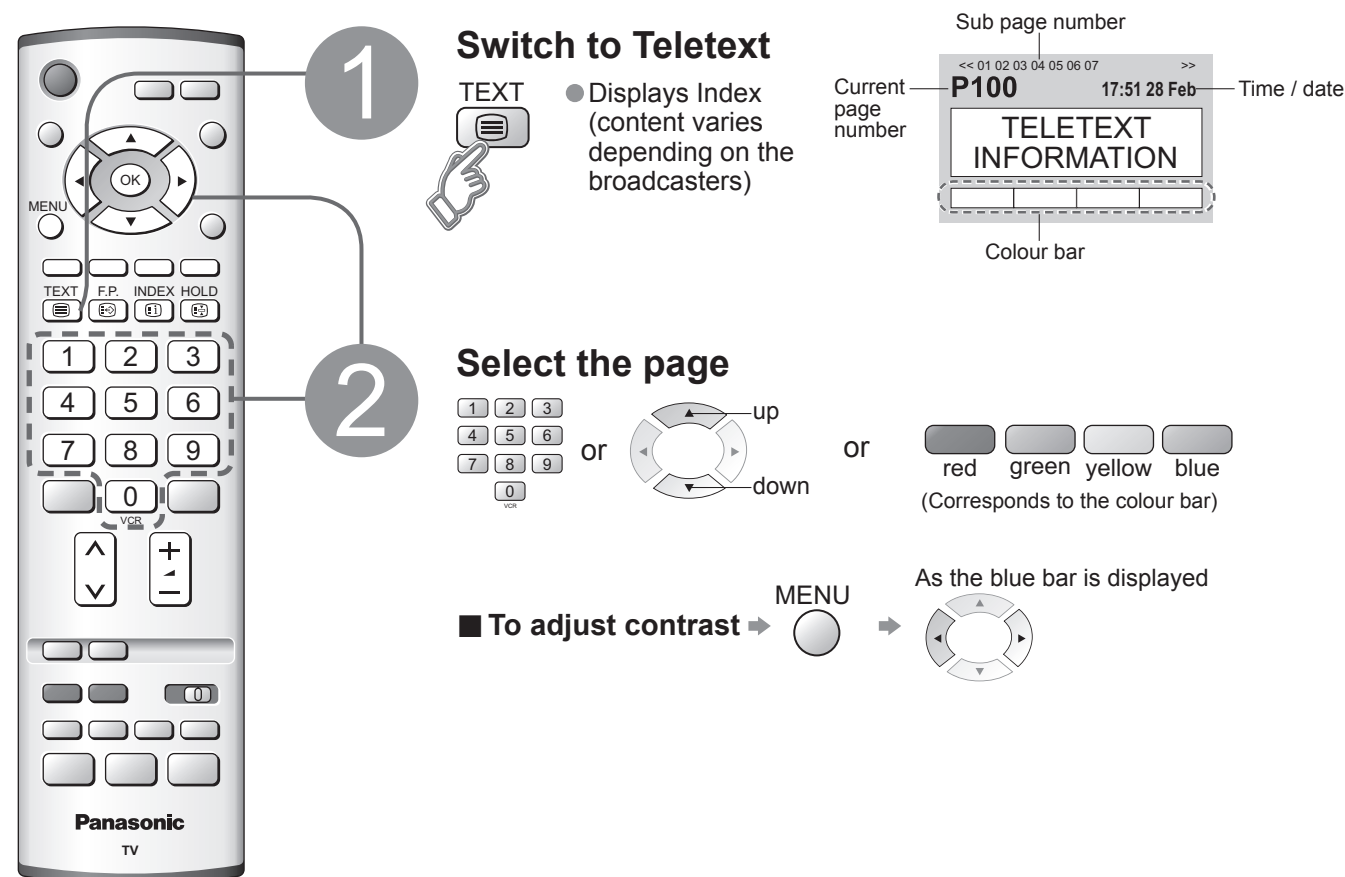

■ To return to TV



■ Using teletext conveniently

Reveal hidden data

Reveal hidden words e.g. quiz page answers



FULL / TOP / BOTTOM

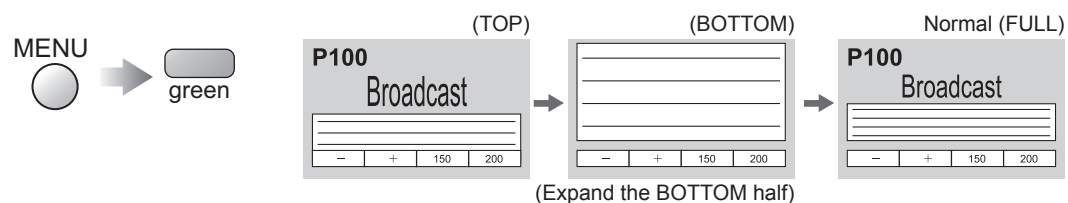

HOLD

If you wish to hold the current page without updating
Stop or resume automatic updating



INDEX

Return to the main index page



Call up a favourite pages

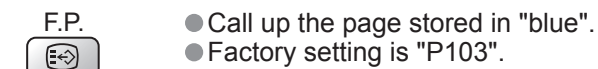

View in multi window

Watch TV and Teletext in two windows at once

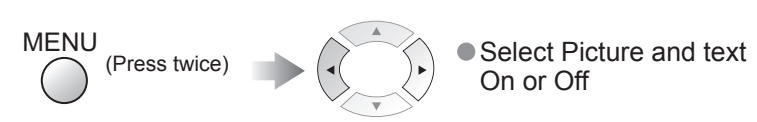

● Operations can be made only in Teletext screen.

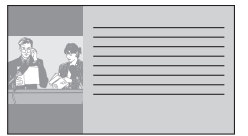

Store frequently viewed pages

Store frequently viewed pages (only on first 25 channels on Programme Guide) in the colour bar

(List mode only)

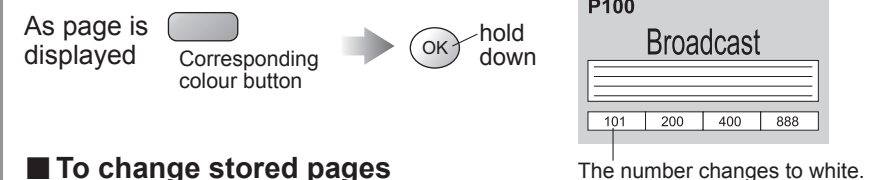

■ To change stored pages

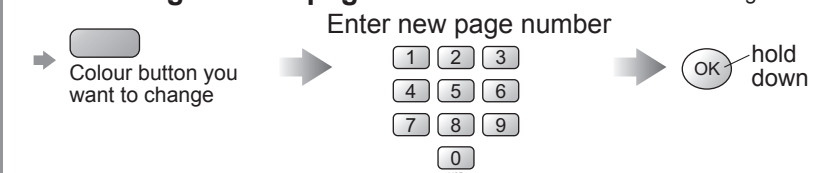

View sub page

View sub page (Only when teletext is more than one page)

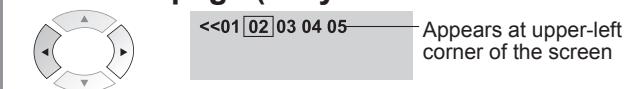

■ To view specific sub page



● Sub pages:
 The number of sub pages varies depending on the broadcasters (up to 79 pages).
 It may take some time for searching, during which time you can watch TV.

Watch TV while waiting for update

View the TV picture while searching for a teletext page

Teletext automatically updates itself when new information becomes available.
 Changes to TV screen temporarily

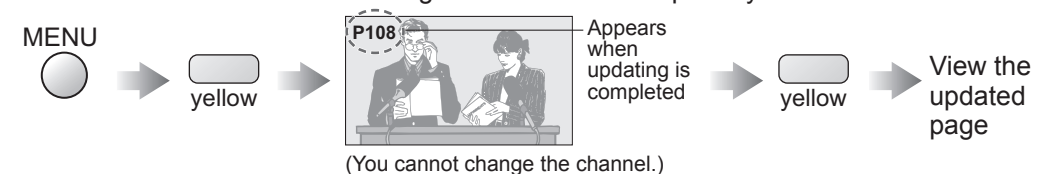

● The news page provides a function that indicates arrival of latest news ("News Flash").

How to Use Menu Functions

Various menus allow you to make settings for the picture, sound, and other functions so that you can enjoy watching TV in your own way.

1

Display menu

MENU

● Displays the functions that can be set (varies according to the input signal)

2

Select the menu

Main menu

Picture menu

Sound menu

Setup menu

(example: Picture menu)

3

Select the item

Picture menu

Viewing mode

Contrast

Brightness

Colour

Sharpness

Tint

Colour balance

Colour management

P-NR

MPEG NR

3D-COMB

(example: Picture menu)

4

Adjust or select

Picture menu

Viewing mode

Contrast

Brightness

Colour

Sharpness

Tint

Colour balance

Colour management

P-NR

MPEG NR

3D-COMB

(example: Picture menu)

① select

② next

select

① change

② store (Required by some functions)

To return to TV



To return to the previous screen



Choose from among alternatives

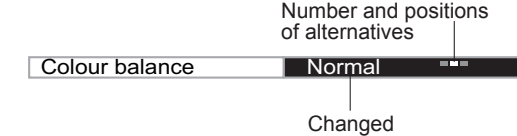

Adjust using the slide bar



Go to the next screen



To reset the setting



Menu list

Menu	Item	Adjustments / Configurations (alternatives)
Picture menu	Viewing mode	Basic picture mode (Dynamic / Normal / Cinema / Auto) ● Set for each input signal Viewing mode Dynamic
	Adjust by each viewing mode	
	Contrast, Brightness, Colour, Sharpness	Adjusts colour, brightness, etc. for each picture mode to suit your taste Contrast - + Brightness - + Colour - + Sharpness - +
	Tint	Adjusts tint of image ● For NTSC signal reception only Tint - +
	Colour balance	Chooses the colour balance of the entire image (Cool / Normal / Warm) Colour balance Normal
	Colour management	Automatically adjusts colours to vivid ones (Off / On) Colour management On
	P-NR	Automatically reduces unwanted picture noise (Off / Normal / Dynamic / Auto) ● Not valid on HDMI, PC, and Analogue component signal P-NR Auto
Sound menu	MPEG NR	Automatically reduces noise for watching DTV, DVD and VCD (Off / Min / Mid / Max) MPEG NR Off
	3D-COMB	Automatically makes still pictures and slow pictures look more vivid (Off / On) ● For PAL or NTSC signal reception only ● Not valid on RGB, S-Video, components, PC and HDMI 3D-COMB On
	Bass	Adjusts the output level of deep bass Bass - +
	Treble	Adjusts the output level of high-pitch, shrill sound Treble - +
	Balance	Adjusts volume level of right and left speakers Balance - +
	Headphone volume	Adjusts the volume of the headphones Headphone volume - +
	MPX	Select stereo / monaural (Mono / Stereo) ● Normally: Stereo ● Stereo signal cannot be received: Mono ● M1 / M2: Available while mono signal is transmitted MPX Stereo
Setup menu	Mode	Improves sound quality for music and dramas (Music / Speech) Mode Music
	Ambience	Gives a greater spatial effect by using dynamic enhancer (Off / On) Ambience Off
	HDMI1 input	Chooses according to the signal when HDMI is connected (Auto / Digital / Analogue) (p. 27) ● HDMI2 terminal is for digital signal only HDMI1 input Auto
	Q-Link	Chooses the connector to which a Q-Link compatible equipment is connected (Off / AV2 / AV3) (p. 24) Q-Link AV2
	AV2/AV3 out	Chooses the signal to be transmitted from the TV to Q-Link (TV / AV1 / AV2 / AV3 / AV4 / Monitor) ● Monitor: Image displayed on screen ● Component signals cannot be outputted AV2 out TV
	Control with HDMI	Control with HDMI function (Off / On) (p. 21) Control with HDMI On
	Teletext	Teletext display mode (TOP (FLOF) / List) (p. 12) Teletext TOP
	Off timer	Sets the time the unit automatically turns Off. (Off / 15 / 30 / 45 / 60 / 75 / 90) (minutes) Off timer Off
	Text language	Selects teletext language (West / East1 / East2) ● West: English, French, German, Greek, Italian, Spanish, Swedish, Turkish ● East1: Czech, English, Estonian, Lettish, Rumanian, Russian, Ukrainian ● East2: Czech, Hungarian, Lettish, Polish, Rumanian Text language West
	Side panel	Increases the brightness of the side panel (Off / Low / Mid / High) ● The recommended setting is High to prevent panel "after-image" Side panel Off
	Power save	Reduces brightness of picture to economise on power consumption (Off / On) Power save Off
	Programme edit	Edits channels (p. 16) Programme edit Access
	Auto setup	Sets channels automatically (p. 18) Auto setup Access
	Manual tuning	Sets channels manually (p. 18) Manual tuning Access
	Fine tuning	Fine tuning of channels (during rain, etc.) Fine tuning - +
Tuning menu	Colour system	Selects optional colour system depending on video signals (Auto / PAL / SECAM / M.NTSC) Colour system Auto
	Volume correc.	Adjusts volume of individual stations Volume correc. - +
	Decoder (AV2 / AV3)	Set "On" when the decoder is connected to AV2 or AV3 terminal via a Q-Link equipment (Off / On) Decoder (AV2) Off
	OSD language	Changes language for on-screen displays OSD language Access
	Colour system	Selects optional colour system based on video signals in AV mode Colour system Auto
Volume correction	Volume correction	Adjusts volume for AV, PC, and HDMI mode Volume correction - +

- A different menu will be displayed while PC is used. (p. 19)
- In AV mode, the Sound menu and Setup menu give a smaller number of options.

How to Use Menu Functions
(picture, sound quality, etc.)

Advanced

Editing and Setting Channels

The current channel settings can be changed according to your needs and reception conditions.



- 1 Display the menu**
MENU
- 2 Select "Setup menu"**
Main menu
Picture menu
Sound menu
Setup menu
- 3 Select "Tuning menu"**
Setup menu
Q-Link
AV2 out
Control with HDMI
Teletext
Off timer
Text language
Side panel
Power save
Tuning menu
OSD language
- 4 Select the function**
Tuning menu
Programme edit
Auto setup
Manual tuning
Fine tuning
Colour system
Volume correc.
Decoder (AV2)
- 5 Set**

■ To exit
EXIT

Edit channels

Programme edit

- Delete
- Add
- Move
- Change channel number
- Change name
- Lock
- Change sound system
- Download to equipment

① Select the programme number to edit

Prog.	Chan.	Name	Lock	Sys
1	CH44	ABC	Off	SC1
2	CH51	XYZ	Off	SC1
3	CH41	FTP	Off	SC1
4	CH47	123	Off	SC1
5	CH37	456	Off	SC1

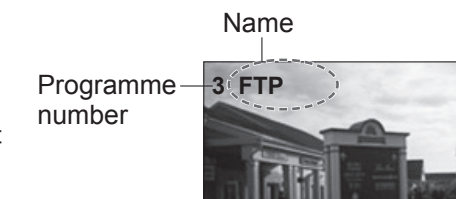

Cursor

② Edit

■ To delete → red → After confirming, press red

■ To add → green → After confirming, press green

■ To move → yellow → Select destination → yellow

■ To change channel number

Prog.	Chan.	Name	Lock	Sys
1	CH44	ABC	Off	SC1
2	CH51	XYZ	Off	SC1
3	CH41	FTP	Off	SC1
4	CH47	123	Off	SC1
5	CH37	456	Off	SC1

Select the "Chan." field

Change number
(Can also be changed with "C" and number buttons)

■ To change the name of the broadcaster displayed when selecting channels

Prog.	Chan.	Name	Lock	Sys
1	CH44	ABC	Off	SC1
2	CH51	XYZ	Off	SC1
3	CH41	FTP	Off	SC1
4	CH47	123	Off	SC1
5	CH37	456	Off	SC1

Select the "Name" field

Select the character

To next character Repeat

Usable characters
ABCDEFGHIJKLMNOPQRSTUVWXYZ0123456789

■ To lock

Prog.	Chan.	Name	Lock	Sys
1	CH44	ABC	Off	SC1
2	CH51	XYZ	Off	SC1
3	CH41	FTP	Off	SC1
4	CH47	123	Off	SC1
5	CH37	456	Off	SC1

Select the "Lock" field

Select "On"
("Off" to unlock)

● You cannot select the channel with number buttons or the "C" button when locked.

■ To change sound system based on signals

Prog.	Chan.	Name	Lock	Sys
1	CH44	ABC	Off	SC1
2	CH51	XYZ	Off	SC1
3	CH41	FTP	Off	SC1
4	CH47	123	Off	SC1
5	CH37	456	Off	SC1

Select the "Sys" field

Select sound system

SC1 : PAL B, G, H / SECAM B, G
SC2 : PAL I
SC3 : PAL D, K / SECAM D, K
F : SECAM L / L'

■ To download channel information to a Q-Link compatible equipment connected to the unit

→ blue → Automatically transmitted (for a few sec.)

● For details (p. 20)

● Not available if "Q-Link" is "Off" in the Setup menu. (p. 14)

③ Store



Editing and Setting Channels

Displaying PC Screen on TV

The screen of the PC connected to the unit can be displayed on the TV.
You can also listen to PC sound with the audio cable connected. To connect PC (p. 24)

1

Select the external input

2

Select "PC"

TV/AV

AV2

AV1 AV2/S AV3/S >>

PC

Displays PC screen

1 blue (To next page)

2 yellow Press twice

TV/AV

To return to TV

Corresponding signals (p. 28)

If "H-freq." or "V-freq." is shown in red, the signals may not be supported.

■ PC menu setting (changed as desired)

● Making settings → "How to Use Menu Functions" ① to ④ (p. 14)

Menu	Item	Adjustments / Configurations(options)
Picture menu	Viewing mode, Contrast, Brightness, Sharpness, Colour balance (p. 14)	
	Advanced setting	W/B High R White balance of bright red area
		W/B High B White balance of bright blue area
		W/B Low R White balance of dark red area
		W/B Low B White balance of dark blue area
Setup menu	Gamma	(2.0 / 2.2 / 2.5 / S Curve)
	Input resolution	Switches to a wide view ● VGA (640 x 480 dots), WVGA (852 x 480 dots), XGA (1,024 x 768 dots), WXGA (1,366 x 768 dots) ● Options change depending on signals
	Clock	Set to the minimum level if noise occurs
	H-pos	Adjust horizontal position
	V-pos	Adjust vertical position
	Clock phase	Eliminate flicker and distortion ● Adjust after Clock adjustment
	Sync	Chooses another synchronous signal if the image is distorted (H&V / On G) ● H&V : by the horizontal and vertical signals from your PC On G : by the green signal from your PC (if available)
Volume correction, Side panel, Power save, OSD language (p. 14)		

● Sound menu (p. 14)

Set automatically Auto setup

Automatically set the channels received in the area

① Start Auto setup

WARNING
All current tuning data will be erased
Start Auto Setup
Exit Return

OK

set

② Select your country

Country
Deutschland
Österreich
Frankreich
Italien
Spanien
Portugal
Niederlande
Dänemark
Schweden
Norwegen
Belgien
Schweiz
ELADIA
Czechia republika
Magyarország
EU

① select

② start

③ Settings are made automatically

CH12
AUTO SETUP IN PROGRESS
SEARCHING : PLEASE WAIT
02 78.01 41
Exit Return

- The settings are downloaded to a Q-Link compatible equipment connected to the unit.
- All previous settings are erased.
- When the sequence is completed, the broadcast of programme number "1" will appear.

Set manually Manual tuning

To freely change settings after Auto setup

① Select the programme number and search through the channel

Programme number
Channel number
Manual tuning
02 78.01 41
Search down/up
Exit Return
Direct entry

② Store

search

OK

③ Repeat ① and ②

Note

● If a VCR is connected with only the RF cable, select programme number "0".

For Manual tuning, using the buttons on the unit ("Tuning mode" on p. 7)

- ① (Press repeatedly until "Tuning mode" appears)
- ② or (Access "Manual tuning")
- ③ (Programme, Channel (select), Sound system)
- ④ or (Change programme or start searching channels)
- ⑤ (Store)
- ⑥ ③-⑤ (Repeat)

■ To return to TV



Programme number (flash)

Channel number (flash)

Sound system (flash)

Channel

External Equipment

Q-Link

Q-Link interlocks the TV unit and VCR / DVD recorder, enables easy recording and playback.

Condition

- Use the VCR / DVD recorder with the following logos:
"Q-Link", "NEXTVIEWLINK", "DATA LOGIC", "Easy Link", "Megalogic", or "SMARTLINK"
- Connect the equipment to this unit's AV2 or AV3 terminal via a "fully-wired" SCART cable. (p. 22)
- Q-Link terminal setup in Setup menu (Q-Link, AV2/AV3 out). (p. 14)

Download channel settings

- Perform Auto setup. (p. 18)
When first using this unit, see "Auto Setup". (p. 9)
- Perform download to the equipment. (p. 16)

Features available

Some recording equipments are not applicable. Read the manuals of the equipment.

What you see is What you record

Information / Message

Power on link and Easy playback

Power off link

Direct TV Recording:
Recording the current programme in VCR / DVD recorder immediately.

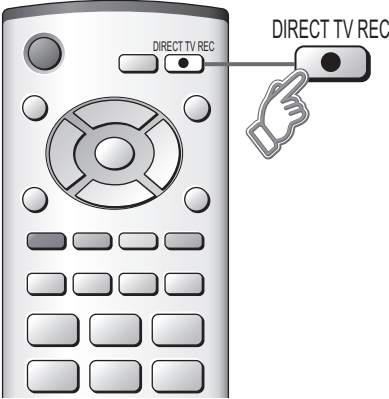

- When Direct TV Recording is performed, the recording equipment is automatically turned on if it is in Standby mode.
- The recording equipment is recording from its own tuner. You can turn the TV off during recording.
- Do not turn the TV off during recording AV source. Otherwise the recording will be stopped.

Recording information or if recording is not possible, a message is displayed. (Only when the programme number is "0" or "AV mode" for some equipment.)

Insert a videocassette or DVD in the recording equipment and it is operated, TV is turned on and input mode is switched automatically so that you can view the content. (Only when TV is in Standby mode.)

When TV is set to Standby mode, the recording equipment is also automatically set to Standby. (Only when the videocassette or DVD is not active.)

● "DATA LOGIC" (a trademark of Metz Corporation) ● "Megalogic" (a trademark of Grundig Corporation)
● "Easy Link" (a trademark of Philips Corporation) ● "SMARTLINK" (a trademark of Sony Corporation)
Read the manuals of the equipment too.

Control with HDMI "HDAVI Control"™*

*Enjoy additional HDMI Inter-Operability with Panasonic products which have "HDAVI Control" function. HDMI connections to some Panasonic equipments (Panasonic DVD Recorder DIGA, Panasonic Player theatre, Panasonic Amplifier, etc.) allow you to enjoy the easy playback or home theatre. About connections, see "Connections" (p. 23). Read the manuals of the equipment too. Non-HDMI-compliant cables cannot be utilized. About applicable equipments, consult your local Panasonic dealer.

Preparations

(For the first time / When adding new equipment, reconnecting equipment or changing setup)
After connection turn the equipment on and then switch the TV unit on. Select the input mode to HDMI1 or HDMI2 (p. 11), and make sure that an image is displayed correctly.

1 Display the menu

2 Select "Setup menu"

3 Select "Control with HDMI"

4 Select "On" (default is On)

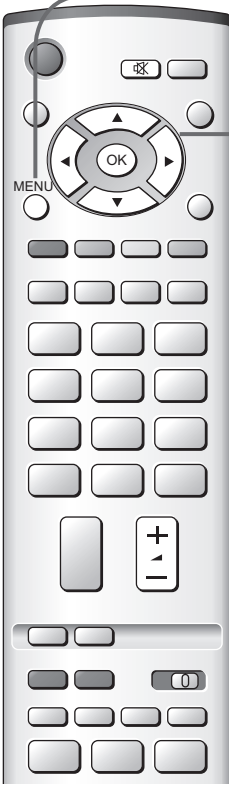

Main menu

- Home theatre
- Picture menu
- Sound menu
- Setup menu

Setup menu

Q-Link	AV2
AV2 out	TV
Control with HDMI	On
Teletext	TOP
Off timer	Off
Text language	West
Side panel	Off
Power save	Off
Tuning menu	
OSD language	

Easy playback

Theatre speaker

Power on link

Power off link

Automatic Input switching-When the connected Panasonic equipment is operated, input mode is switched automatically. When it is stopped operating, input mode is returned.

You can control the theatre speaker with TV's remote control. This function is available when Panasonic Amplifier or Player theatre is connected.

1 Display the menu

2 Select "Home theatre" or "TV speaker"

Main menu

- Home theatre
- Picture menu
- Sound menu
- Setup menu

Home theatre:
Adjustment for equipment (automatically turned on if it is in Standby mode)
Volume up / down →
Mute →

TV speaker:
TV speakers are active.

● When selecting "Home theatre", the sound of TV speakers is mute.
● When the equipment is turned off, TV speakers will be active.

When the connected Panasonic equipment is operated, TV is also automatically turned on and the content is reproduced. (Only when TV is in Standby mode.)

When TV is set to Standby mode, the connected Panasonic equipment is also automatically set to Standby.

External Equipment

Connections

● External equipments and cables shown are not supplied with this TV.

■ Connect VCR / DVD recorder (Recording, Playback)

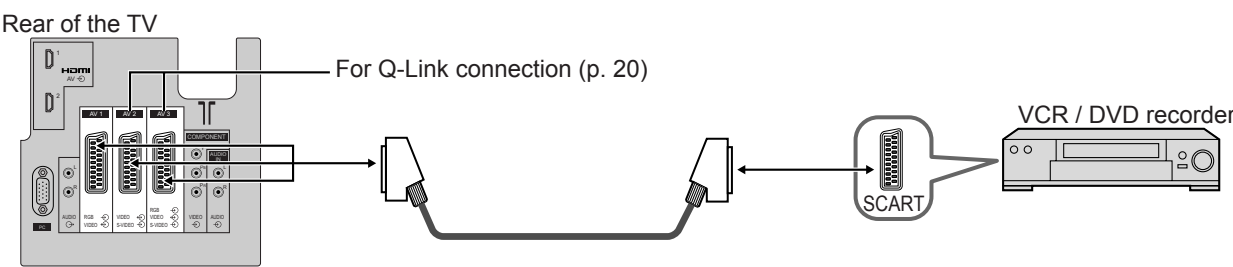

■ Connect DVD player (Playback)

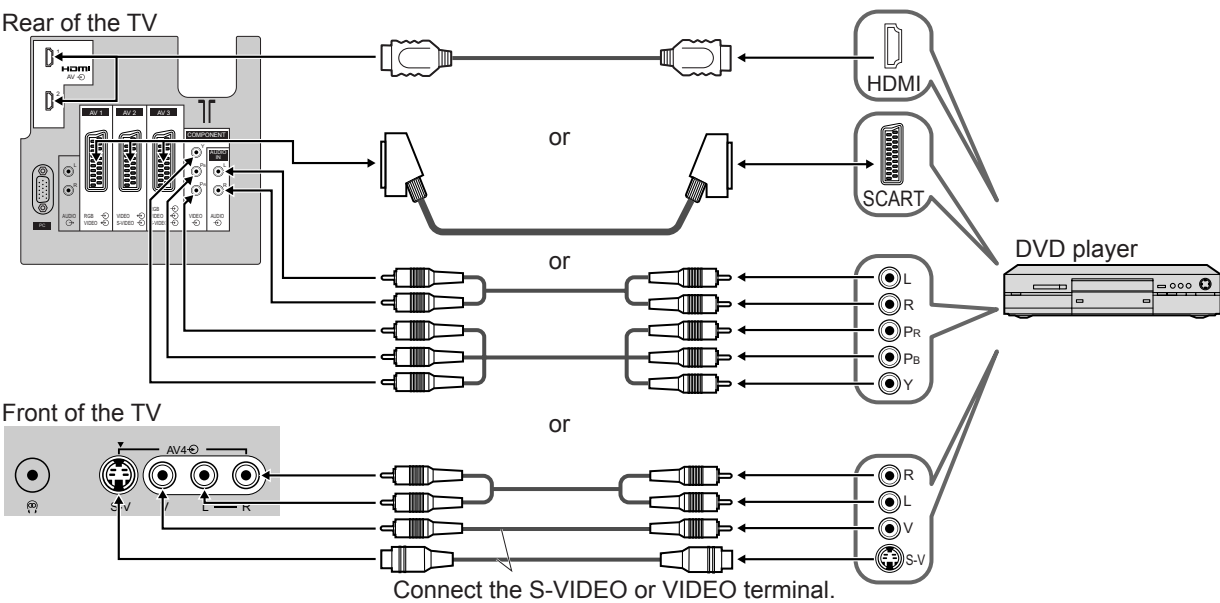

■ Connect Set top box (RGB input)

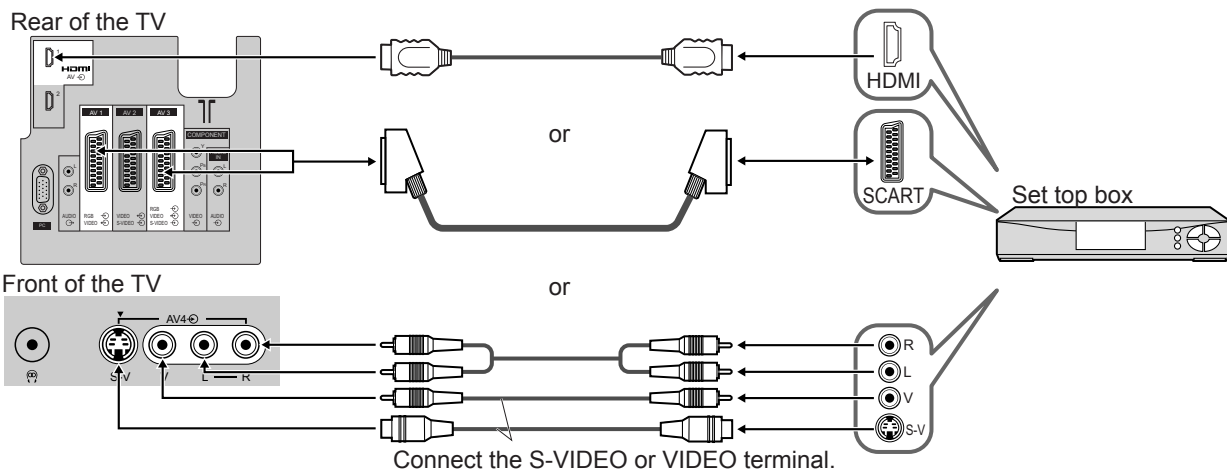

■ Connect VCR / DVD recorder and Set top box (example)

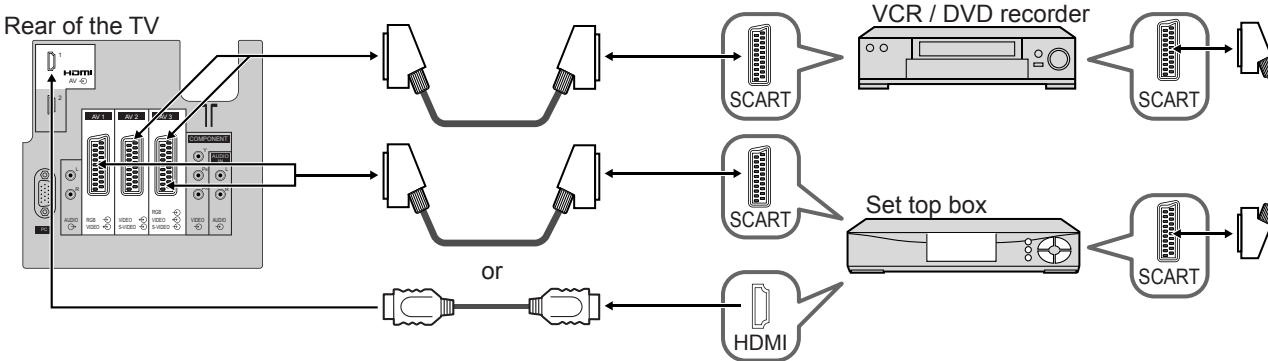

■ Connect DVD recorder and VCR (example)

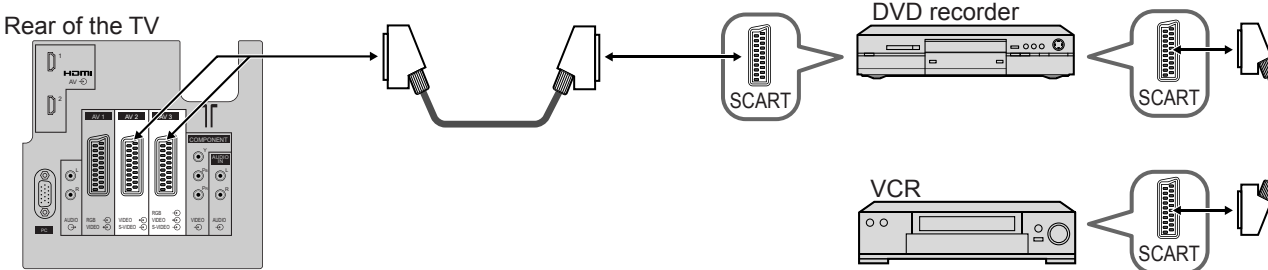

Control with HDMI (p. 21)

■ Easy playback (For connection to HDMI2 terminal, refer to p. 24)

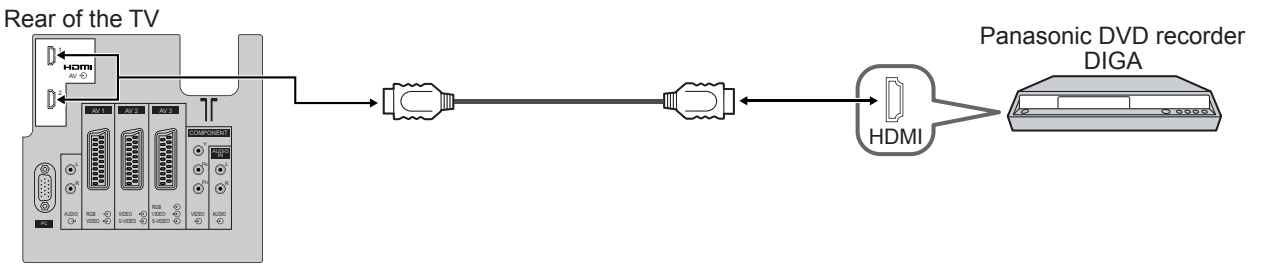

■ Home theatre

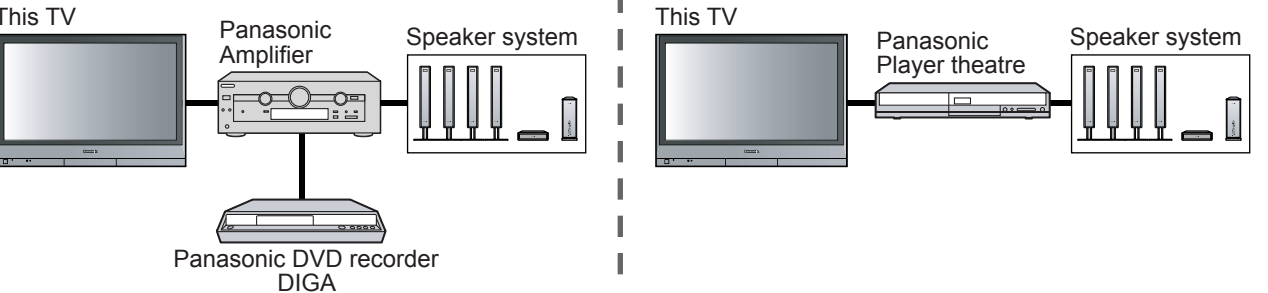

Read the manuals of Panasonic Amplifier or Player theatre for details.

● It is recommended that you use Panasonic's HDMI cable.
Recommended part number:
RP-CDHG15 (1.5 m)
RP-CDHG30 (3.0 m)
RP-CDHG50 (5.0 m)





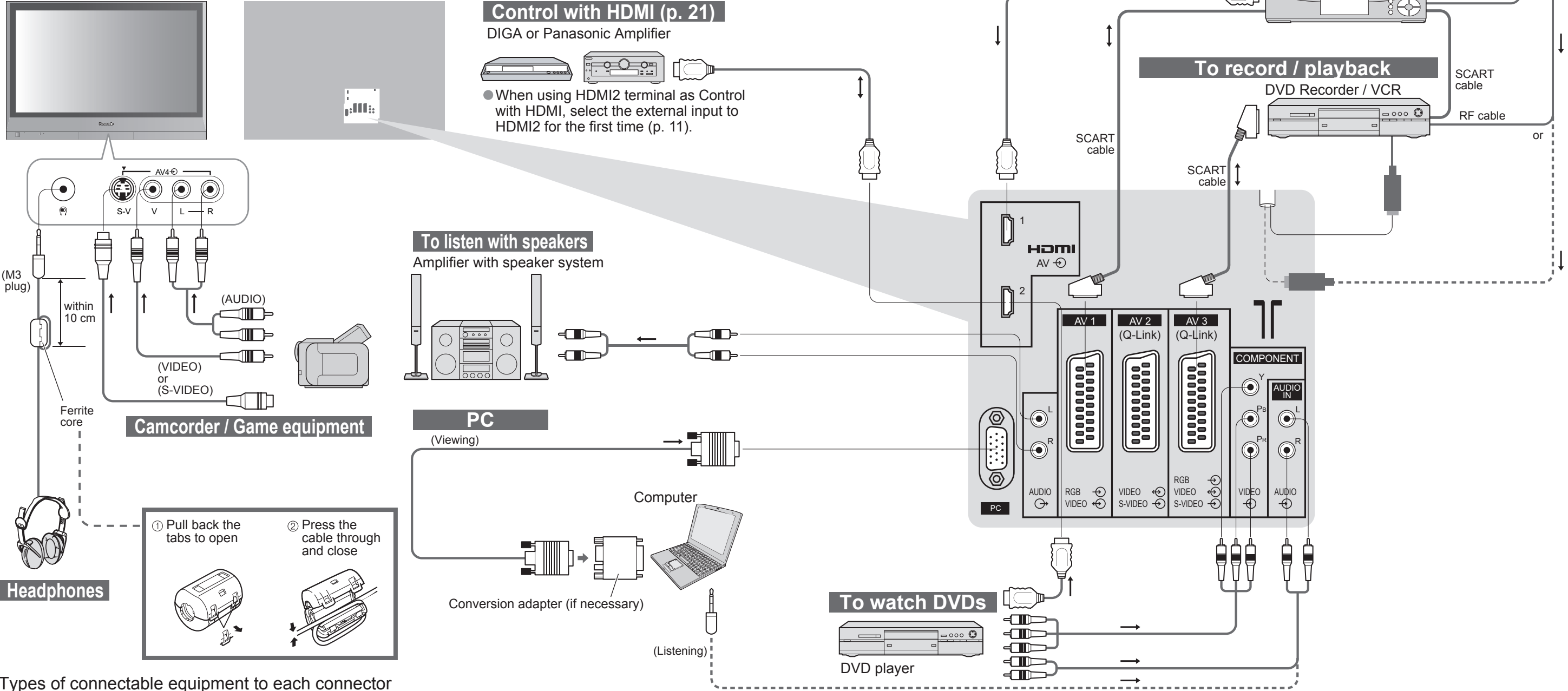

External Equipment

Connections (overview)

These diagrams show our recommendations for how to connect the TV unit to your various equipment. For other connections, consult the instructions of each equipment, the table below, and the specifications (p. 31).



Types of connectable equipment to each connector

Connector	 AV1	 AV2	 AV3	 AV4	 COMPONENT	 HDMI	
Recording / Playback (equipment)						1	2
■ To record / playback videocassettes / DVDs (VCR / DVD recorder)	<input type="radio"/>	<input type="radio"/>	<input type="radio"/>				
■ To watch DVDs (DVD player)	<input type="radio"/>	<input type="radio"/>	<input type="radio"/>	<input type="radio"/>	<input type="radio"/>	<input type="radio"/>	<input type="radio"/>
■ To watch camcorder images (Video camera)	<input type="radio"/>	<input type="radio"/>	<input type="radio"/>	<input type="radio"/>			
■ To watch satellite broadcasts (Set top box)	<input type="radio"/>		<input type="radio"/>	<input type="radio"/>		<input type="radio"/>	<input type="radio"/>
■ To play games (Game equipment)	<input type="radio"/>		<input type="radio"/>	<input type="radio"/>			
■ Q-Link		<input type="radio"/>	<input type="radio"/>				
■ Control with HDMI						<input type="radio"/>	<input type="radio"/>

○: Recommended Connection

Technical Information

Aspect Ratio

The optimum size and aspect can be chosen, and you can enjoy finer images. (p. 10)

■ **Auto aspect:** Auto aspect determines the best aspect ratio to use to fill your screen. It does this using a four step process to determine if the picture being viewed is a widescreen picture.

If Auto aspect detects a widescreen signal it switches into the appropriate 16:9 or 14:9 widescreen mode. If Auto aspect does not detect a widescreen signal then this advanced TV set enhances the picture for optimum viewing pleasure.

The text shown on the screen indicates how Auto aspect determined which ratio to use:

"WIDE" appears in the top left of the screen if a widescreen identification signal (WSS) is found or a signal found through a SCART terminal. Auto aspect switches to the appropriate 16:9 or 14:9 widescreen ratio. This function will also work in any aspect mode. "Auto aspect" appears in the top left of the screen if black stripes above and below the picture are detected. Auto aspect chooses the best ratio and expands the picture to fill the screen. This process can take several minutes, depending on the darkness of the picture.

Signal name		Aspect modes									Aspect Control Signal								
											Widescreen signal (WSS)						Control signal through SCART terminal (pin 8)		
		Auto aspect	16:9	14:9	Just	4:3	4:3 Full	Zoom1	Zoom2	Zoom3	TV	AV1	AV2	AV3	AV4	Component	AV1	AV2	AV3
TV/AV1/AV2/AV3/AV4	PAL	○	○	○	○	○	—	○	○	○	○	○	○	○	○	—	○	○	○
	PAL 525/60	○	○	○	○	○	—	○	○	○	—	—	—	—	—	—	○	○	○
	M.NTSC	○	○	○	○	○	—	○	○	○	—	—	—	—	—	—	○	○	○
	NTSC (AV input only)	○	○	○	○	○	—	○	○	○	—	—	—	—	—	—	○	○	○
Component/HDMI	525(480)/60i	○	○	○	○	○	—	○	○	○	—	—	—	—	—	—	—	—	—
	525(480)/60p	○	○	○	○	○	—	○	○	○	—	—	—	—	—	—	—	—	—
	625(576)/50i	○	○	○	○	○	—	○	○	○	—	—	—	—	—	○	—	—	—
	625(576)/50p	○	○	○	○	○	—	○	○	○	—	—	—	—	—	○	—	—	—
	750(720)/50p	○	○	○	○	○	○	○	○	○	—	—	—	—	—	—	—	—	—
	750(720)/60p	○	○	○	○	○	○	○	○	○	—	—	—	—	—	—	—	—	—
	1125(1080)/50i	○	○	○	○	○	○	○	○	○	—	—	—	—	—	—	—	—	—
	1125(1080)/60i	○	○	○	○	○	○	○	○	○	—	—	—	—	—	—	—	—	—
PC input		—	○	—	—	○	—	—	—	—	—	—	—	—	—	—	—	—	—

- Note**
- The ratio varies depending on the programme, etc. If the ratio is greater than the standard "16:9", black bands may appear at the top and bottom of the screen.
 - If the screen size looks unusual when a widescreen-recorded programme is played back on a VCR, adjust the tracking of the VCR. (See the VCR manual.)
 - To select the ratio manually: (Only "16:9" or "4:3" in PC mode)

16:9



Directly displays the image at "16:9" without distortion (anamorphic).

14:9



Displays the image at the standard "14:9" without enlargement.

Just

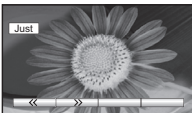

Displays a 4:3 image full-screen. Stretching is only noticeable at the left and right edges.

4:3



Displays the image at the standard "4:3" without distortion.

4:3 Full

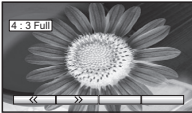

Displays a "4:3" image enlarged horizontally to fit the screen.

Zoom1

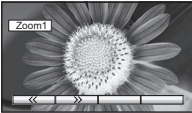

Displays a "16:9" letterbox or "4:3" image without distortion.

Zoom2

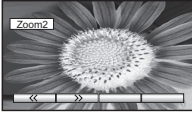

Displays a "16:9" letterbox (anamorphic) image full-screen without distortion.

Zoom3

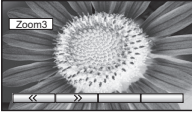

Displays a "2.35:1" letterbox (anamorphic) image full-screen without distortion. At "16:9", displays the image at its maximum (with slight enlargement).

HDMI connection

HDMI (high-definition multimedia interface) allows you to enjoy high-definition digital images and high-quality sound by connecting the TV unit and the equipment.

HDMI-compatible equipment (*1) with an HDMI or DVI output terminal, such as a set top box or a DVD player, can be connected to the HDMI terminal using an HDMI compliant (fully wired) cable.

- HDMI is the world's first complete digital consumer AV interface complying with a non-compression standard.
- If the external equipment has only a DVI output, connect to the HDMI1 terminal via a DVI to HDMI adapter cable (*2).
- When the DVI to HDMI adapter cable is used, connect the audio cable to the audio input terminal.
- Audio settings can be made on the "HDMI1 input" menu screen. (p. 14)
- Applicable audio signal sampling frequencies (2ch L.PCM): 48 kHz, 44.1 kHz, 32 kHz

(*1): The HDMI logo is displayed on an HDMI-compliant equipment. (*2): Enquire at your local digital equipment retailer shop.

- Note**
- HDMI2 terminal is for digital signal only.
 - Use with a PC is not assumed.
 - The 720p/1080i signals will be reformatted before being displayed on the screen.
 - If the connected equipment has an aspect adjustment function, set the aspect ratio to "16:9".
 - These HDMI connectors are "type A".
 - An equipment having no digital output terminal may be connected to the input terminal of either "Component", "S-VIDEO", or "Video" to receive analogue signals.
 - The HDMI input terminal can be used with only the following image signals: 480i, 480p, 576i, 576p, 720p and 1080i. Match the output setting of the digital equipment.
 - For details of the applicable HDMI signals, see p. 28.

PC connection

A PC may be connected to this TV unit so that the PC screen is displayed and sound is heard from the TV.

- PC signals that can be inputted: Horizontal scanning frequency 31 to 69 kHz; vertical scanning frequency 59 to 86 Hz (more than 1,024 signal lines could result in incorrect display of the image).
- A PC adapter is not necessary for the DOS/V-compliant D-sub 15-pin connector.

- Note**
- Some PC models cannot be connected to this TV unit.
 - For details of the applicable PC signals, see p. 28.
 - Max. display resolution

Aspect	Model No.	TH-37PV60EH	TH-42PV60EH
4:3		768 × 720 dots	768 × 768 dots
16:9		1,024 × 720 dots	1,024 × 768 dots

- D-sub 15-pin connector signal

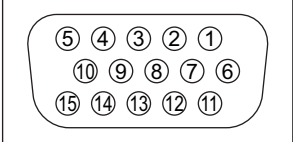

Pin No.	Signal Name	Pin No.	Signal Name	Pin No.	Signal Name
①	R	⑥	GND (Ground)	⑪	NC (not connected)
②	G	⑦	GND (Ground)	⑫	NC (not connected)
③	B	⑧	GND (Ground)	⑬	HD/SYNC
④	NC (not connected)	⑨	NC (not connected)	⑭	VD
⑤	GND (Ground)	⑩	GND (Ground)	⑮	NC (not connected)

Control with HDMI

HDMI connections to some Panasonic equipments allow you to enjoy the easy playback or home theatre.

- Setup the equipment to enable this function. Read the manual of the equipment.
- This function may not work normally depending on the equipment condition.
- This function may not work normally when Panasonic Player theatre is connected.
- The equipment can be operated by TV's remote control with this function on even if TV is in Standby mode.
- Image or sound may not be available for the first few seconds when the playback starts.
- Image or sound may not be available for the first few seconds when Input mode is switched.
- Volume function will be displayed when adjusting the volume of the equipment.
- Easy playback is also available by using the remote control for Amplifier. Read the manuals of Amplifier.

Technical Information

SCART and S-video terminal information

■ AV1 SCART terminal (RGB, VIDEO)

Suitable inputs for AV1 include RGB (Red / Green / Blue).

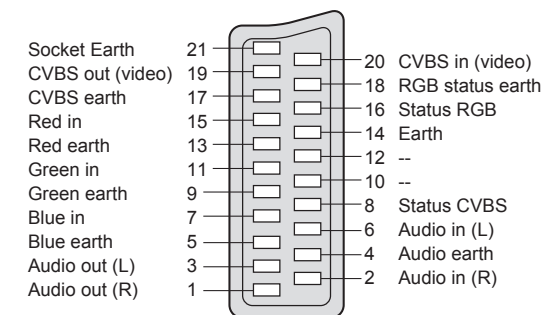

■ AV2 SCART terminal (VIDEO, S-VIDEO, Q-Link)

AV2 - Pins 15 and 20 are dependent on AV2 S-VHS / VIDEO switching.

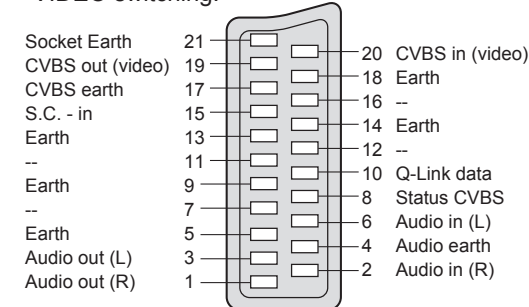

■ AV3 SCART terminal (RGB, VIDEO, S-VIDEO, Q-Link)

AV3 - Pins 15 and 20 are dependent on AV3 S-VHS / VIDEO switching.

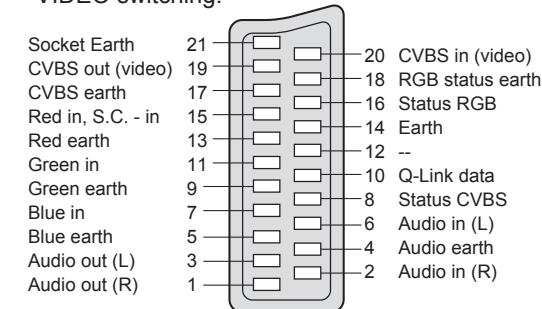

■ AV4 S-VIDEO 4 pin terminal

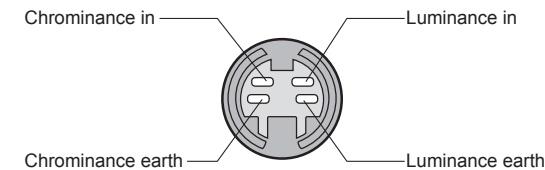

Input signal that can be displayed

* Mark: Applicable input signal for Component (Y, P_B, P_R), HDMI and PC (D-sub 15P)

Signal name	Horizontal frequency (kHz)	Vertical frequency (Hz)	Component	HDMI	PC
525 (480) / 60i	15.73	59.94	*	*	
525 (480) / 60p	31.47	59.94	*	*	
625 (576) / 50i	15.63	50.00	*	*	
625 (576) / 50p	31.25	50.00	*	*	
750 (720) / 60p	45.00	60.00	*	*	
750 (720) / 50p	37.50	50.00	*	*	
1,125 (1,080) / 60i	33.75	60.00	*	*	
1,125 (1,080) / 50i	28.13	50.00	*	*	
640 × 400 @70 Hz	31.46	70.07			*
640 × 480 @60 Hz	31.47	59.94			*
640 × 480 @75 Hz	37.50	75.00			*
800 × 600 @60 Hz	37.88	60.32			*
800 × 600 @75 Hz	46.88	75.00			*
800 × 600 @85 Hz	53.67	85.06			*
1,024 × 768 @60 Hz	48.36	60.00			*
1,024 × 768 @70 Hz	56.48	70.07			*
1,024 × 768 @75 Hz	60.02	75.03			*
1,024 × 768 @85 Hz	68.68	85.00			*
1,280 × 1,024 @60 Hz	63.98	60.02			*
Macintosh13" (640 × 480)	35.00	66.67			*
Macintosh16" (832 × 624)	49.72	74.54			*
Macintosh21" (1,152 × 870)	68.68	75.06			*

Note

- Signals other than above may not be displayed properly.
- The above signals are reformatted for optimal viewing on your display.

FAQs

Before requesting service or assistance, please follow these simple guides to resolve the problem. If problem still persists, please contact your local Panasonic dealer or Panasonic Customer Care Centre for assistance.

White spots or shadow images (noise)



- Check the position, direction, and connection of the aerial.

VIERA logo appears at the four corners of the screen

Contrast is reduced

- The function to prevent after-image is activated. (Not a faulty symptom)
- The screen saver is activated if the TV unit is not operated for a certain time in AV mode.
- Contrast is lowered when radio, menu, etc. lasts for several minutes.
- "after-image" (p. 5)

Only one part remains dark

- A pixel or luminescent spot may occasionally be missing in plasma displays. (Not a faulty symptom)

Pictures from an equipment are unusual when the equipment is connected via HDMI

- Is the HDMI cable connected properly? (p. 24)
- Turn Off the TV unit and equipment, then turn them On again.
- Check an input signal from the equipment. (p. 28)
- Use an equipment compliant with EIA/CEA-861/861B.

The remote control does not work

- Are the batteries installed correctly? (p. 6)
- Has the TV unit been switched On?

FAQs

	Problem	Actions
Screen	Chaotic image, noisy	<ul style="list-style-type: none">● Set "P-NR" in the Picture menu (to remove noise). (p. 14)● Check nearby electrical products (car, motorcycle, fluorescent lamp).
	No image can be displayed	<ul style="list-style-type: none">● Is "Colour" or "Contrast" in the Picture menu set to the minimum? (p. 14)
	Blurry or distorted image (no sound or low volume)	<ul style="list-style-type: none">● Reset channels. (p. 18)
Sound	Neither image nor sound is produced	<ul style="list-style-type: none">● Is the unit in "AV mode"?● Is the mains lead plugged into the socket outlet?● Is the TV unit turned On?● Check Picture menu (p. 14) and volume.
	No sound is produced	<ul style="list-style-type: none">● Is "Sound Mute" active? (p. 7)● Is the volume set to the minimum?
	Sound level is low or sound is distorted	<ul style="list-style-type: none">● Sound signal reception may be deteriorated.● Set "MPX" (p. 14) in the Sound menu to "Mono".
	Whirling sound is heard	<ul style="list-style-type: none">● The sound is from built-in cooling fan (not a sign of faulty operation).
	Sound is unusual	<ul style="list-style-type: none">● Set the sound setting of the connected equipment to "2ch L.PCM".● Check the "HDMI1 input" setting in the Sound menu. (p. 14)● If digital sound connection has a problem, select analogue sound connection. (p. 27)
HDMI	An error message appears	<ul style="list-style-type: none">● Contact the authorized Service Centre.
	"Control with HDMI" function does not work	<ul style="list-style-type: none">● Switch the TV unit on again with the equipment on.● Set "Control with HDMI" to "Off", then set to "On" again. (p. 21)
	TV unit goes into "Standby mode"	<ul style="list-style-type: none">● The sleep function is activated.● The TV unit enters "Standby mode" about 30 min. after broadcasting ends.
Other	An error message appears	<ul style="list-style-type: none">● Follow the message's instructions.● If the problem persists, contact the authorized Service Centre.

Licence

Trademark Credits

- VGA is a trademark of International Business Machines Corporation.
- Macintosh is a registered trademark of Apple Computer, USA.
- S-VGA is a registered trademark of the Video Electronics Standard Association.
Even if no special notation has been made of company or product trademarks, these trademarks have been fully respected.
- HDMI, the HDMI Logo and High-Definition Multimedia Interface are trademarks or registered trademarks of HDMI Licensing LLC.
- HDAVI Control™ is a trademark of Matsushita Electric Industrial Co., Ltd.

Specifications

	TH-37PV60EH	TH-42PV60EH
Power Source	AC 220-240 V, 50 / 60 Hz	
Power Consumption	Average use	241 W
	Standby condition	0.3 W
Plasma Display panel	Drive method	AC type
	Aspect Ratio	16:9
	Contrast Ratio	Max 10000:1
Visible screen size	94 cm	106 cm
	818 mm (W) × 461 mm (H) × 939 mm (diagonal)	920 mm (W) × 518 mm (H) × 1,056 mm (diagonal)
No. of pixels	737,280 (1,024 (W) × 720 (H)) [3,072 × 720 dots]	786,432 (1,024 (W) × 768 (H)) [3,072 × 768 dots]
Sound	Speaker	12 cm × 6 cm × 2 pcs, 8 Ω
	Audio Output	20 W (10 W + 10 W), 10% THD
	Headphones	M3 (3.5 mm) Jack × 1
PC signals	VGA, SVGA, XGA SXGA (compressed) Horizontal scanning frequency 31 - 69 kHz Vertical scanning frequency 59 - 86 Hz	
Receiving Systems / Band name	PAL B, G, H, I, SECAM B, G, SECAM L / L' VHF E2 - E12 VHF A - H (ITALY) CATV (S01 - S05) CATV S11 - S20 (U1 - U10)	
	VHF H1 - H2 (ITALY) UHF E21 - E69 CATV S1 - S10 (M1 - M10) CATV S21 - S41 (Hyperband)	
	PAL D, K, SECAM D, K VHF R1 - R2 VHF R6 - R12	
	VHF R3 - R5 UHF E21 - E69	
Aerial - Rear	PAL 525/60 Playback of NTSC tape from some PAL Video recorders (VCR)	
	M. NTSC Playback from M. NTSC Video recorders (VCR)	
Operating Conditions	NTSC (AV input only) Playback from NTSC Video recorders (VCR)	
	VHF / UHF	
Connection Terminals	Temperature : 0 °C - 40 °C	
	AV1 (Scart terminal)	21 Pin terminal (Audio/Video in, Audio/Video out, RGB in)
	AV2 (Scart terminal)	21 Pin terminal (Audio/Video in, Audio/Video out, S-Video in, Q-Link)
	AV3 (Scart terminal)	21 Pin terminal (Audio/Video in, Audio/Video out, RGB in, S-Video in, Q-Link)
	AV4	VIDEO RCA PIN Type × 1 1.0 V[p-p] (75 Ω)
		S-VIDEO Mini DIN 4-pin Y:1.0 V[p-p] (75 Ω) C:0.286 V[p-p] (75 Ω)
		AUDIO L - R RCA PIN Type × 2 0.5 V[rms]
	Others	COMPONENT Y 1.0 V[p-p] (including synchronization) ±0.35 V[p-p]
		HDMI1/2 TYPE A Connectors
		PC HIGH-DENSITY D-SUB 15PIN R,G,B/0.7 V[p-p] (75 Ω) HD, VD/TTL Level 2.0 - 5.0 V[p-p] (high impedance)
Output	AUDIO L - R	RCA PIN Type × 2 0.5 V[rms]
	AUDIO L - R	RCA PIN Type × 2 0.5 V[rms] (high impedance)
Dimensions (W × H × D)	917 mm × 645 mm × 95 mm (TV Set only)	
	917 mm × 708 mm × 320 mm (With Pedestal)	
Weight	1,020 mm × 705 mm × 95 mm (TV Set only)	
	1,020 mm × 768 mm × 320 mm (With Pedestal)	
	26.0 kg Net (TV Set only)	
	28.0 kg Net (With Pedestal)	
	30.0 kg Net (TV Set only)	
	32.0 kg Net (With Pedestal)	

Note

- Design and Specifications are subject to change without notice. Weight and Dimensions shown are approximate.
- This equipment complies with the EMC standards listed below.
EN55013, EN61000-3-2, EN61000-3-3, EN55020, EN55022, EN55024.